

SUITE TYPE B1

836 sq ft

1803-31A Street,
Vernon, BC

Suites 201, 301,
401 501



Second floor

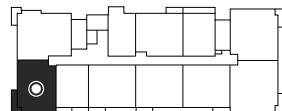

Third floor

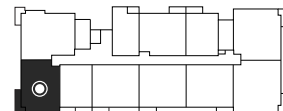

Fourth floor

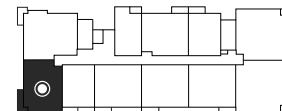

Fifth floor

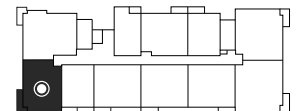

SUMMITVIEW
HEIGHTS
SKYLINE LIVING

All room measurements are preliminary based on current building concept and unit configurations and are subject to change.