



MONARCH APARTMENTS

3554-A Ryder Hesjedal Way
Colwood, BC

TIDAL 850 sq ft

The floor plan illustrated here includes these finishes:



CABINERY:
FLAT SLAB

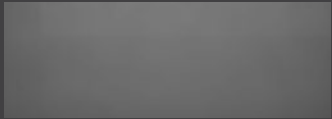

COUNTERS:
QUARTZ



FLOORING:
LUXURY
VINYL PLANK



CARPET:
TEXTURED
CUT PILE



All suite measurements are preliminary based on current building concept and unit configurations and are subject to change.



MONARCH
APARTMENTS

3554-A Ryder Hesjedal Way
Colwood, BC

TIDAL
850 sq ft

Fourth Floor – Fifth Floor

Suites: 406, 506

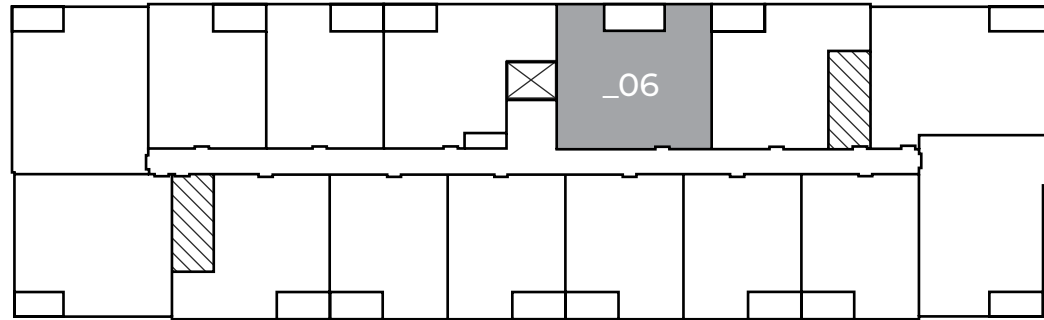

 Elevator  Stairwell