



UPLANDS TERRACE APARTMENTS

6117 Uplands Drive
Nanaimo, BC

GALIANO

903 sq ft



CABINETS:
FLAT PANEL

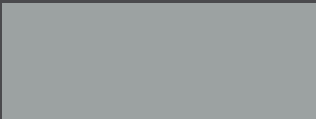

COUNTERS:
QUARTZ



FLOORING:
LUXURY
VINYL PLANK

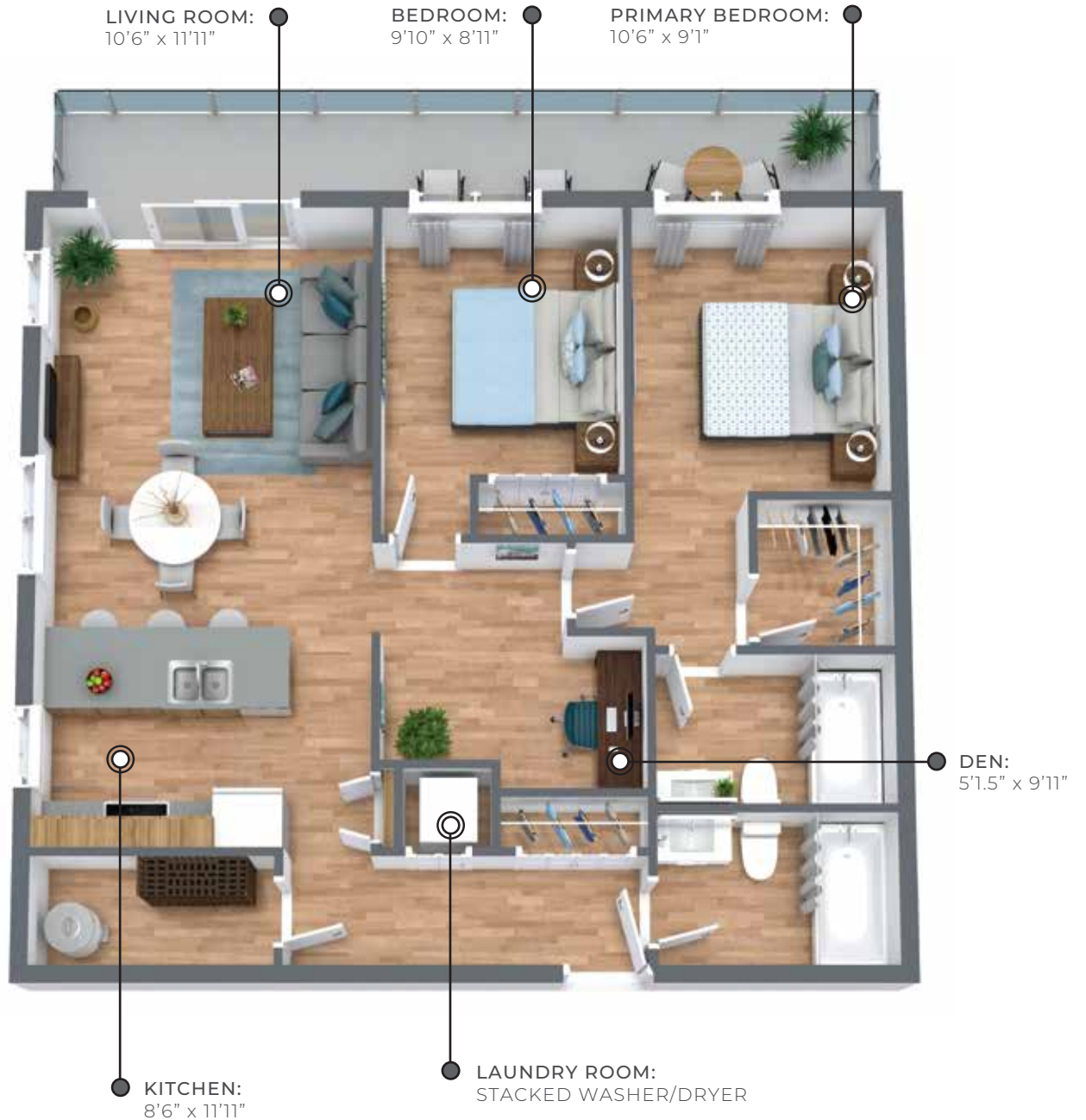

All suite measurements are preliminary based on current building concept and unit configurations and are subject to change.
uplandsterrace.ca



UPLANDS TERRACE

APARTMENTS

6117 Uplands Drive
Nanaimo, BC

GALIANO

903 sq ft

First Floor

Suite 101, 123

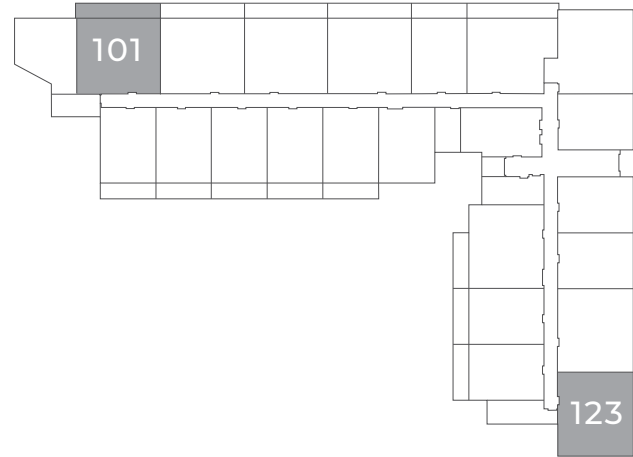

Second Floor - Fifth Floor

Suites 201, 223, 301, 323, 401, 423, 501, 523

