



BROOKSIDE TERRACE APARTMENTS

120 Tilbury Avenue,
Bedford, NS

HORSESHOE

1199 sq ft

The floor plan illustrated here includes these finishes:

CABINETS:



White High-gloss White Charcoal

COUNTERS:



Laminate Quartz

FLOORING:

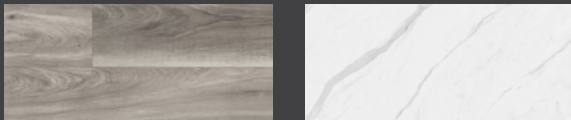

Luxury vinyl plank Ceramic tile

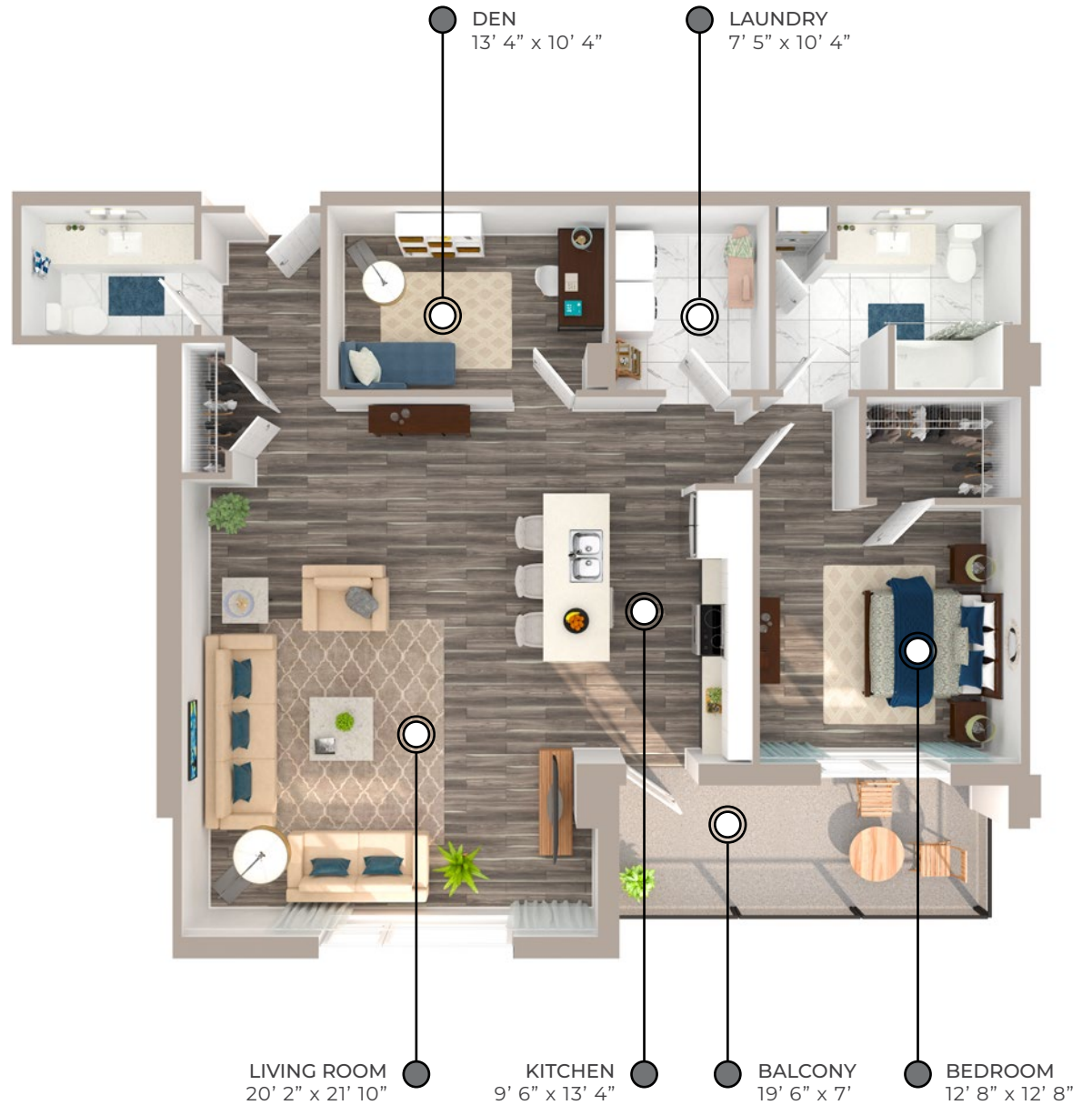

Please note, all floor plans and photos are provided for illustrative purposes only. **ALL MEASUREMENTS ARE APPROXIMATE.** Actual layouts may be different than shown and could vary in size and scale.



**BROOKSIDE
TERRACE**
APARTMENTS

120 Tilbury Avenue,
Bedford, NS

HORSESHOE

1199 sq ft

First Floor

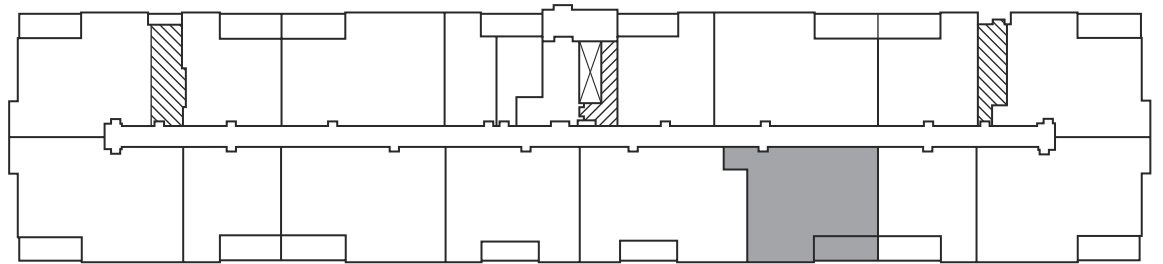

Second Floor – Sixth Floor

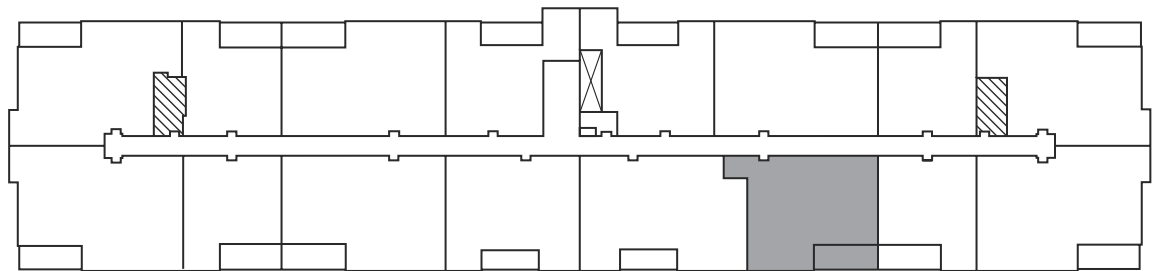

 Elevator  Stairwell