



HIGH PARK PLACE APARTMENTS

985 Maxwell Street
Sarnia, ON

1 BEDROOM
714-797 sq ft

FINISHES:

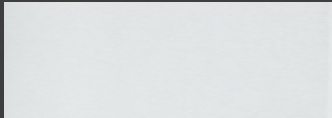

CABINETRY:
FLAT PANEL

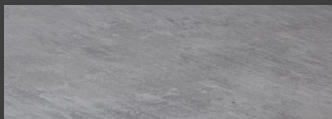

COUNTERS:
QUARTZ



FLOORING:
LUXURY
VINYL PLANK

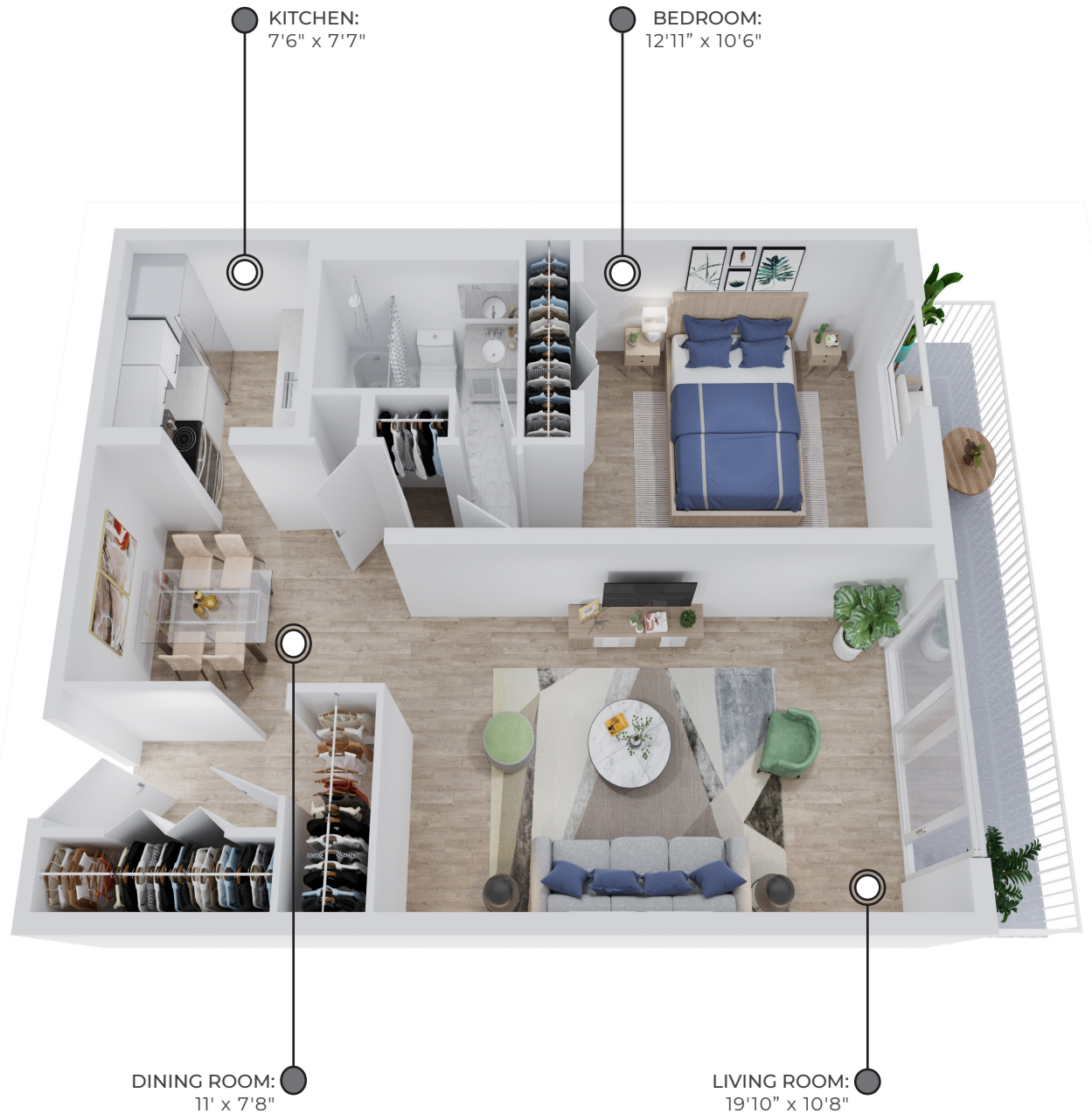

DINING ROOM:
11' x 7'8"

LIVING ROOM:
19'10" x 10'8"

All suite measurements are preliminary based on current building concept and unit configurations and are subject to change.
skylineliving.ca



HIGH PARK PLACE APARTMENTS

985 Maxwell Street
Sarnia, ON

1 BEDROOM
714-797 sq ft

FINISHES:

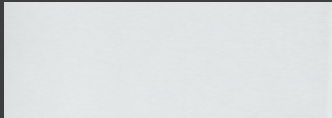

CABINETRY:
FLAT PANEL

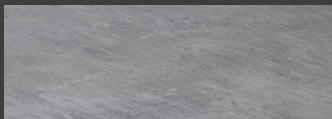

COUNTERS:
QUARTZ



FLOORING:
LUXURY
VINYL PLANK

First Floor

Suites: 103, 105, 107, 109, 111, 112, 115

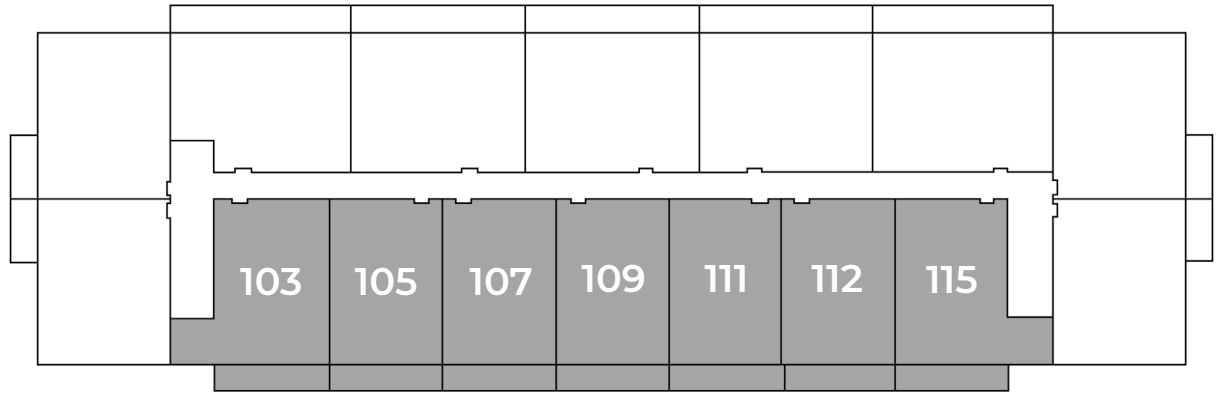

Second Floor - Fourth Floor

Suites: 205, 207, 209, 211, 212, 215, 305, 307, 309,
311, 312, 315, 405, 407, 509, 411, 412, 415

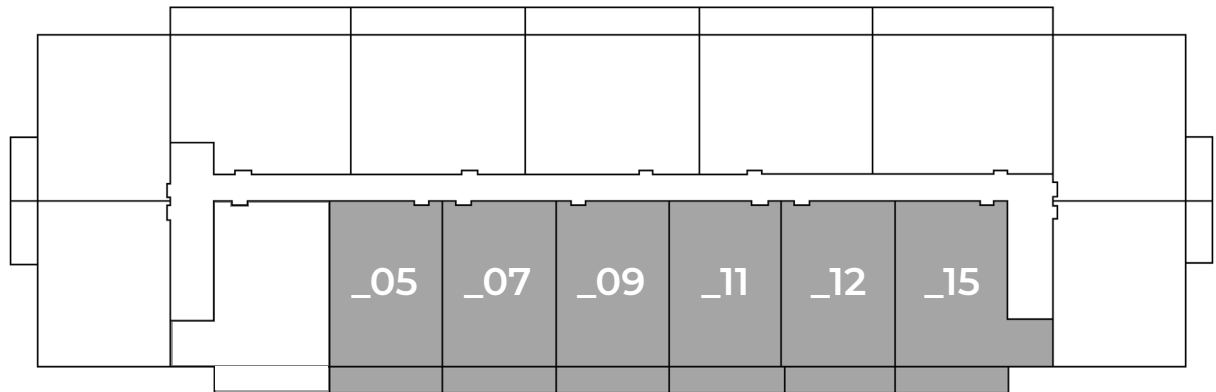

All suite measurements are preliminary based on current building concept and unit configurations and are subject to change.
skylineliving.ca



HIGH PARK PLACE APARTMENTS

985 Maxwell Street
Sarnia, ON

1 BEDROOM
801 sq ft

FINISHES:

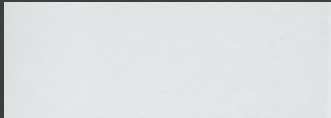

CABINETY:
FLAT PANEL



COUNTERS:
QUARTZ



FLOORING:
LUXURY
VINYL PLANK



All suite measurements are preliminary based on current building concept and unit configurations and are subject to change.
skylineliving.ca



HIGH PARK PLACE APARTMENTS

985 Maxwell Street
Sarnia, ON

1 BEDROOM

801 sq ft

FINISHES:

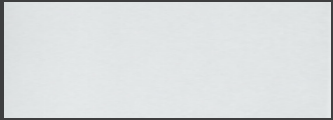

CABINETY:
FLAT PANEL

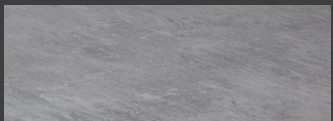

COUNTERS:
QUARTZ



FLOORING:
LUXURY
VINYL PLANK

Second Floor - Fourth Floor
Suites: 203, 303, 403

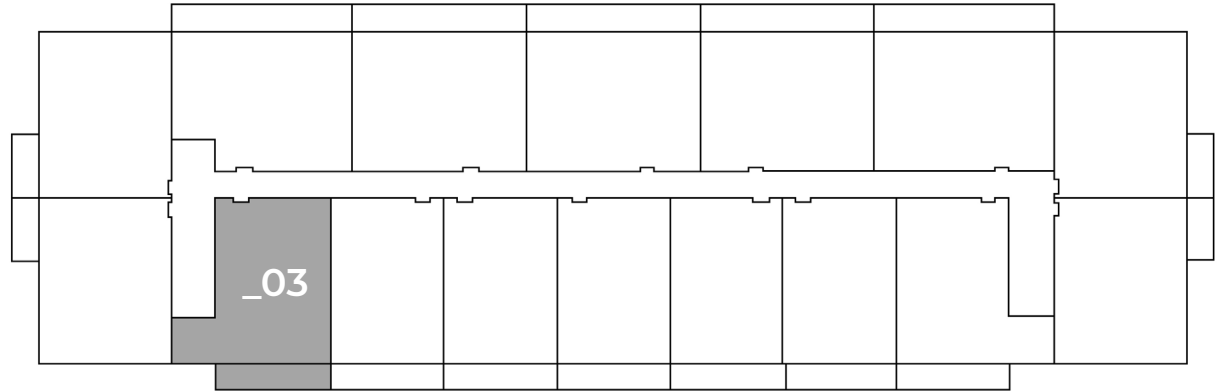

All suite measurements are preliminary based on current building concept and unit configurations and are subject to change.
skylineliving.ca