



MEREWOOD APARTMENTS

377 & 385 Moilliet Street South
Parksville, BC

PLUM
664-718 sq ft

The floor plan illustrated here
includes these finishes:



CABINETS:
FLAT SLAB



COUNTERS:
QUARTZ



FLOORING:
LUXURY
VINYL TILE



- | | | | | |
|--|-----------------------------------|--------------------------------|-------------------------------|-------------------------------------|
| 1 Kitchen/Dining
14' 8" x 18' 5" | 2 Living Room
14' x 11' | 3 Den
11' 5" x 9' 7" | 4 Bathroom
5' x 10' | 5 Bedroom
11' 5" x 14' 8" |
| 6 Laundry
3' x 5' | 7 Balcony
8' 8" x 9' 9" | | | |

Please note, all floor plans and photos are provided for illustrative purposes only. ALL MEASUREMENTS ARE APPROXIMATE. Actual layouts may be different than shown and could vary in size and scale. merewoodapartments.ca



MEREWOOD APARTMENTS

377 & 385 Moilliet Street South
Parksville, BC

PEAR 719 sq ft

The floor plan illustrated here
includes these finishes:

CABINETRY:
FLAT SLAB

COUNTERS:
QUARTZ

FLOORING:
LUXURY
VINYL TILE

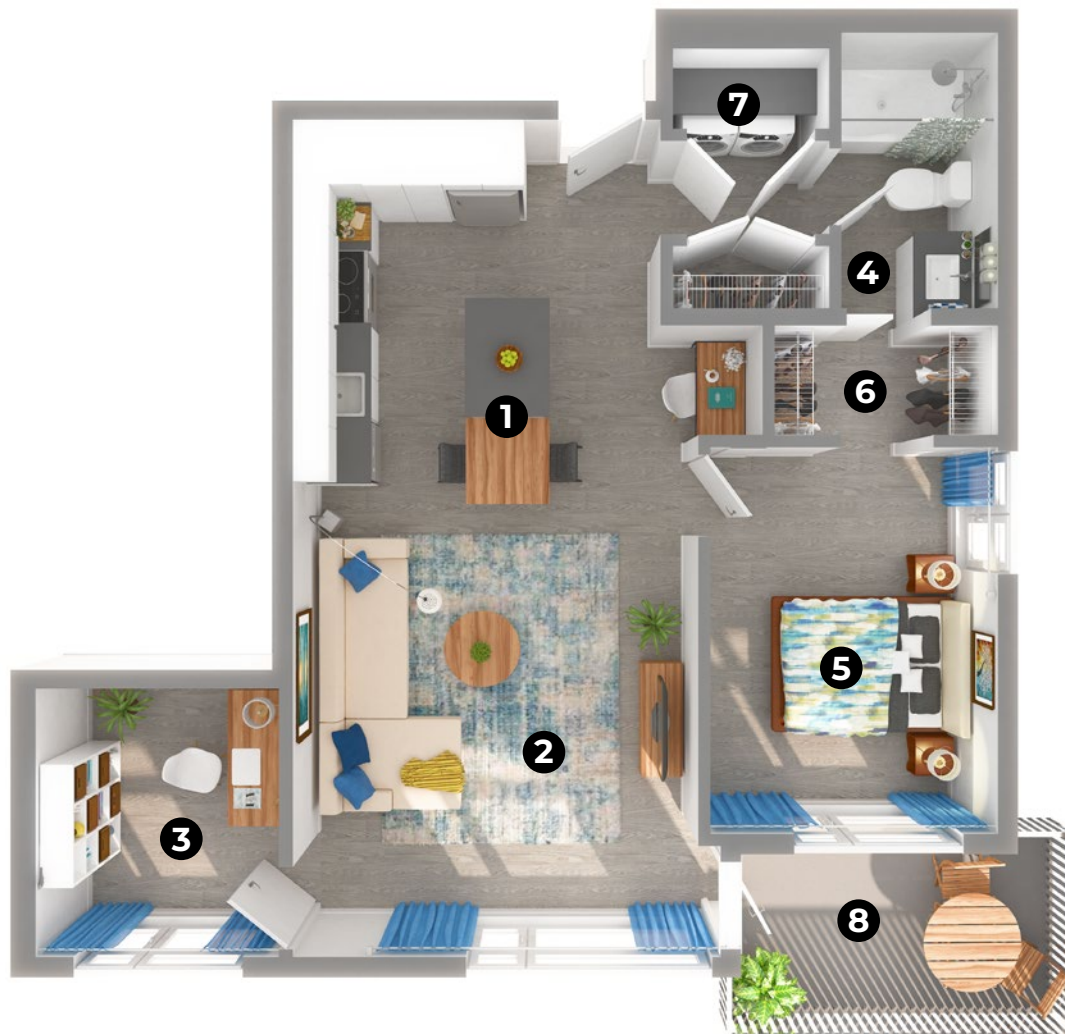

- | | | | | |
|---|---|---------------------------------|-------------------------------|-------------------------------------|
| 1 Kitchen/Dining
11' 10" x 12' 4" | 2 Living Room
13' 4" x 12' 4" | 3 Den
9' 8" x 9' 2" | 4 Bathroom
10' x 5' | 5 Bedroom
11' 5" x 12' 5" |
| 6 Walk-thru Closet
10' x 3' 9" | 7 Laundry
3' 4" x 6' 10" | 8 Balcony
7' x 10' 2" | | |

Please note, all floor plans and photos are provided for illustrative purposes only. ALL MEASUREMENTS ARE APPROXIMATE. Actual layouts may be different than shown and could vary in size and scale. merewoodapartments.ca



MEREWOOD APARTMENTS

411 & 423 Despard Avenue
Parksville, BC

ROSE 632 sq ft

The floor plan illustrated here
includes these finishes:



CABINETRY:
FLAT SLAB

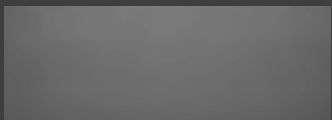

COUNTERS:
QUARTZ

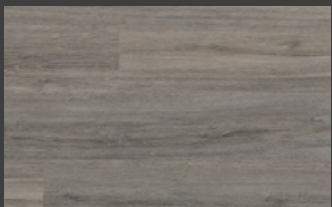

FLOORING:
LUXURY
VINYL TILE



CARPET:
TEXTURED
CUT PILE

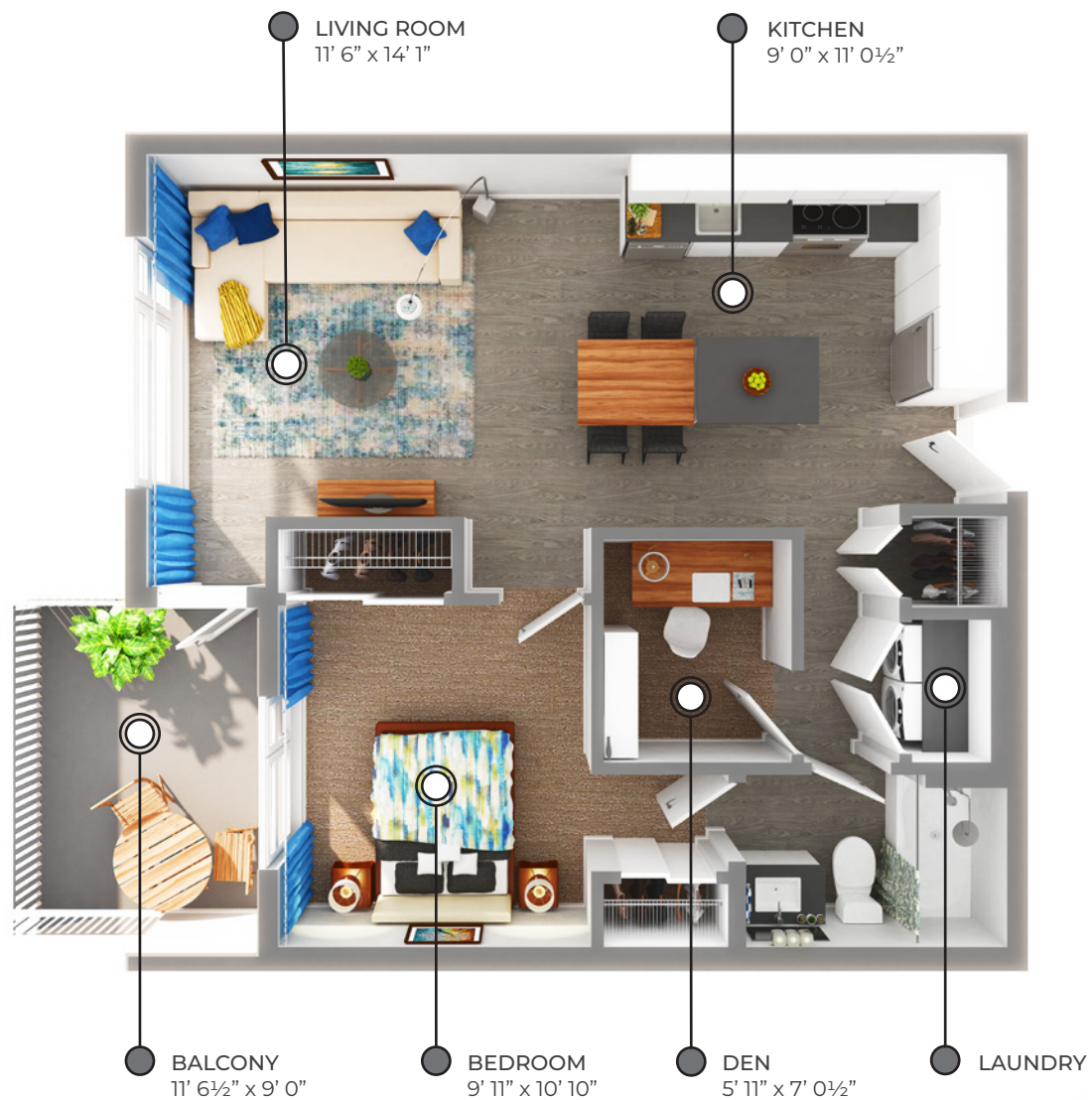

All suite measurements are preliminary based on current building concept and unit configurations and are subject to change.



MEREWOOD APARTMENTS

411 & 423 Despard Avenue
Parksville, BC

LILAC

643 sq ft

The floor plan illustrated here
includes these finishes:



CABINETRY:
FLAT SLAB

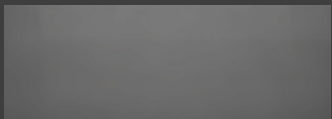

COUNTERS:
QUARTZ

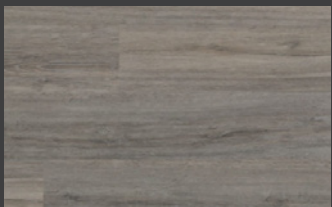

FLOORING:
LUXURY
VINYL TILE



CARPET:
TEXTURED
CUT PILE

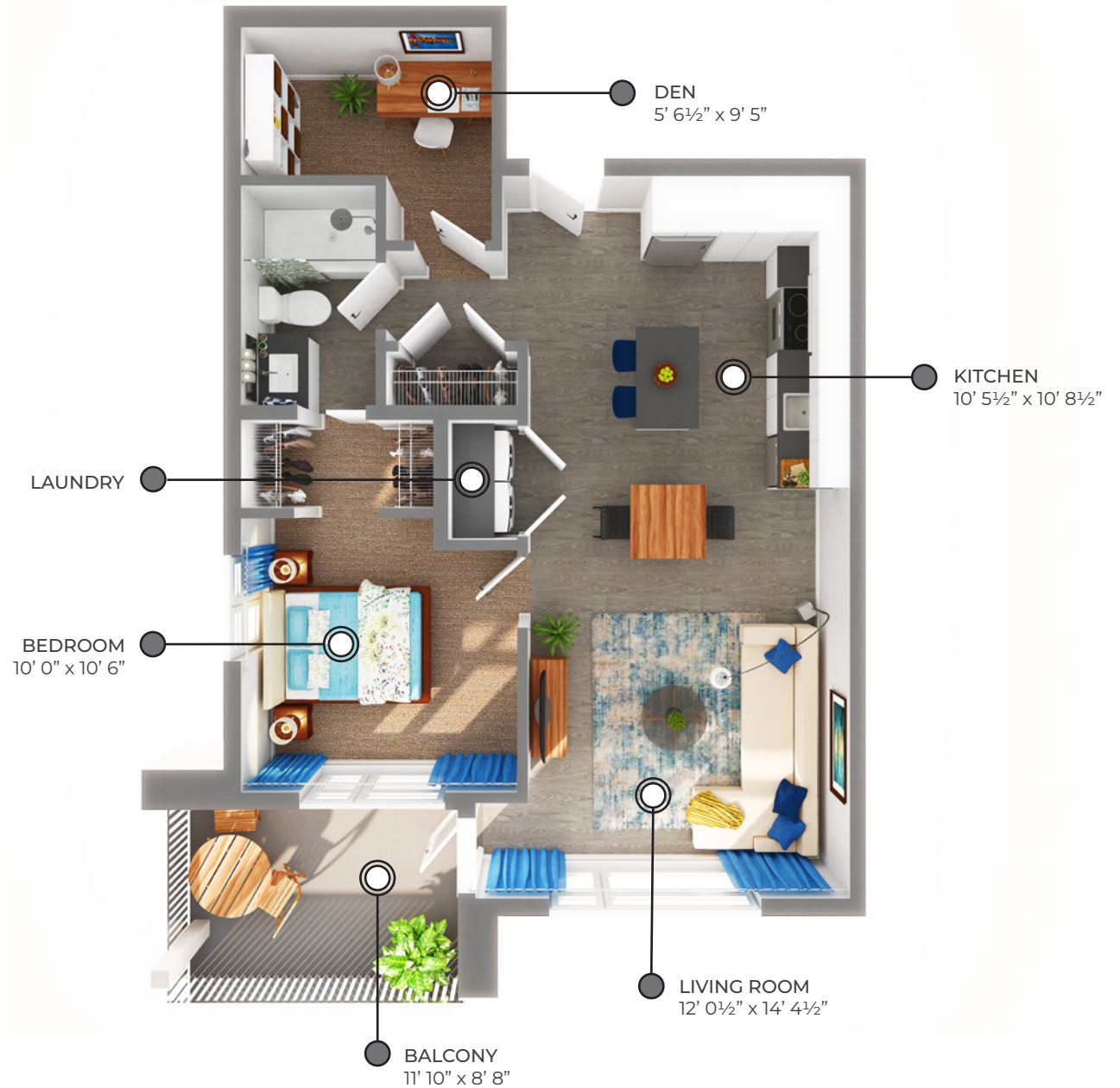

All suite measurements are preliminary based on current building
concept and unit configurations and are subject to change.



MEREWOOD APARTMENTS

411 & 423 Despard Avenue
Parksville, BC

MAGNOLIA

667 sq ft

The floor plan illustrated here
includes these finishes:



CABINETS:
FLAT SLAB

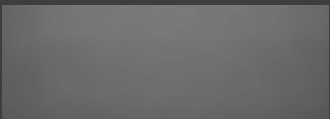

COUNTERS:
QUARTZ

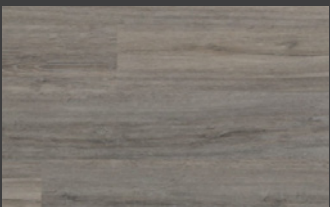

FLOORING:
LUXURY
VINYL TILE



CARPET:
TEXTURED
CUT PILE

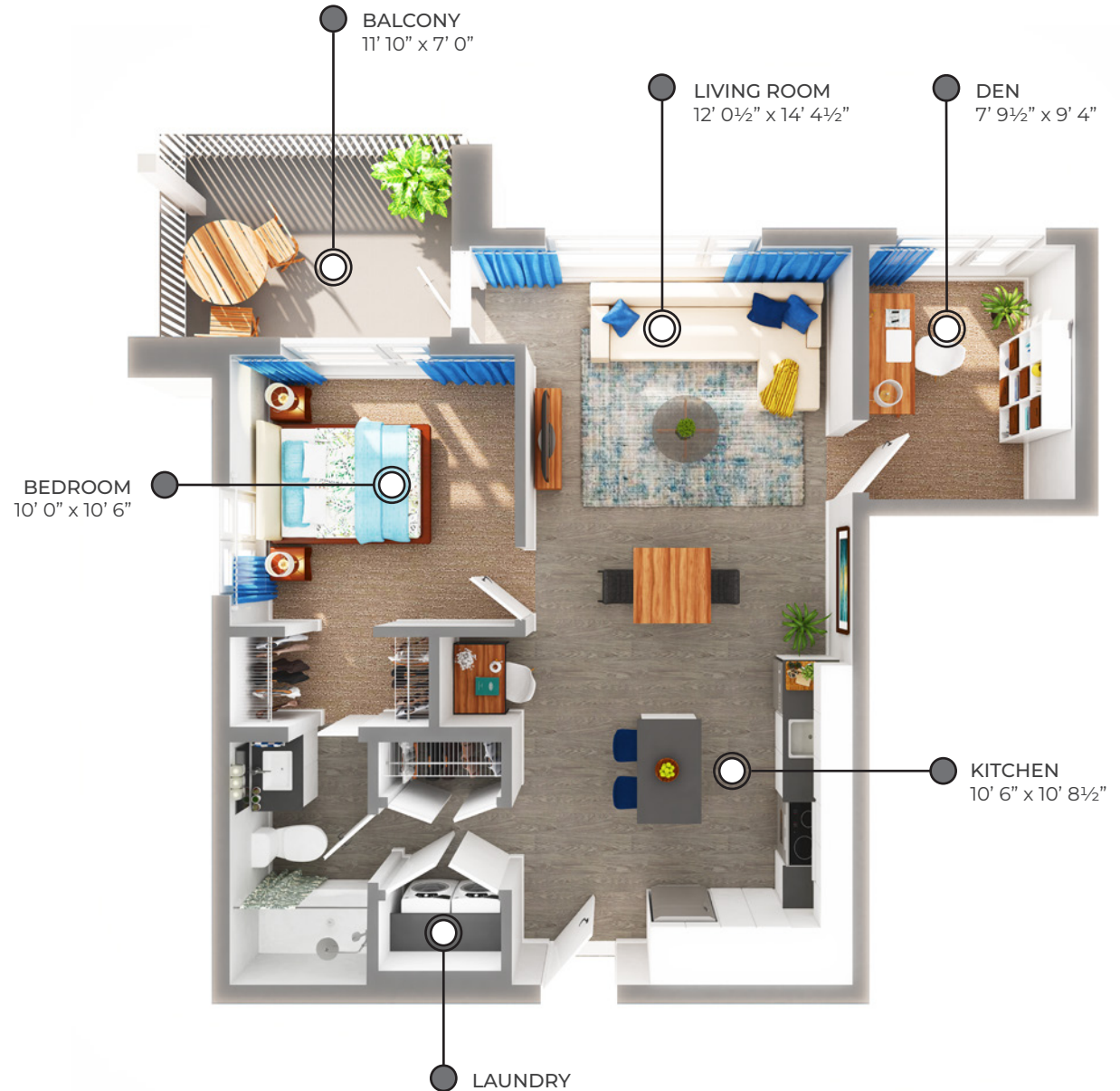

All suite measurements are preliminary based on current building concept and unit configurations and are subject to change.



MEREWOOD APARTMENTS

411 & 423 Despard Avenue
Parksville, BC

PEAR
688-695 sq ft

The floor plan illustrated here
includes these finishes:

CABINETRY:
FLAT SLAB

COUNTERS:
QUARTZ

FLOORING:
LUXURY
VINYL TILE

CARPET:
TEXTURED
CUT PILE

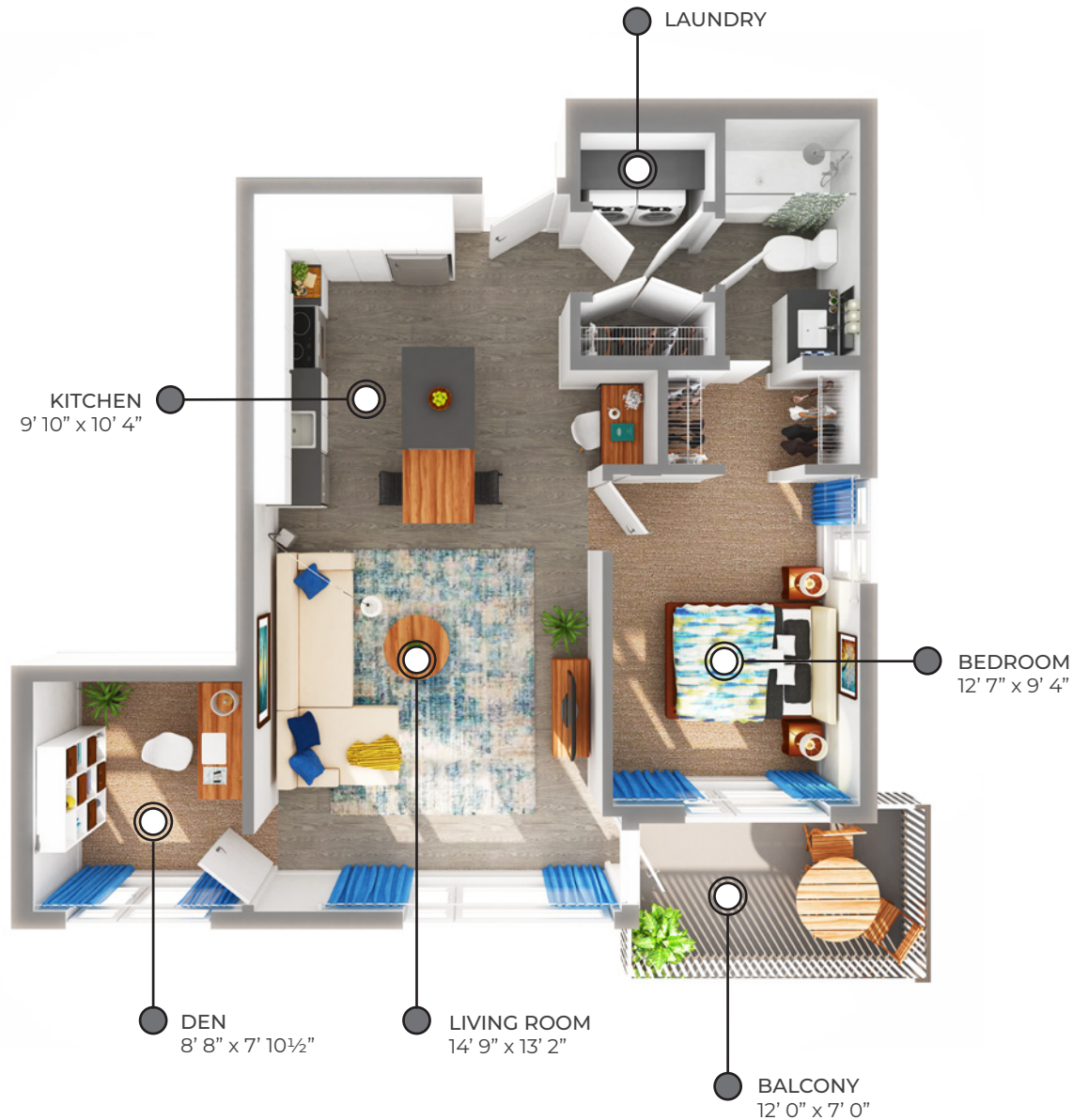

All suite measurements are preliminary based on current building concept and unit configurations and are subject to change.



MEREWOOD APARTMENTS

411 & 423 Despard Avenue
Parksville, BC

PLUM 714 sq ft

The floor plan illustrated here
includes these finishes:



CABINETRY:
FLAT SLAB

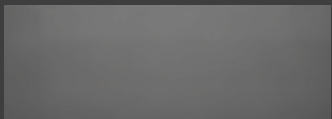

COUNTERS:
QUARTZ

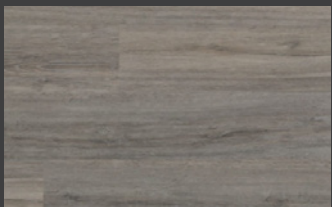

FLOORING:
LUXURY
VINYL TILE



CARPET:
TEXTURED
CUT PILE

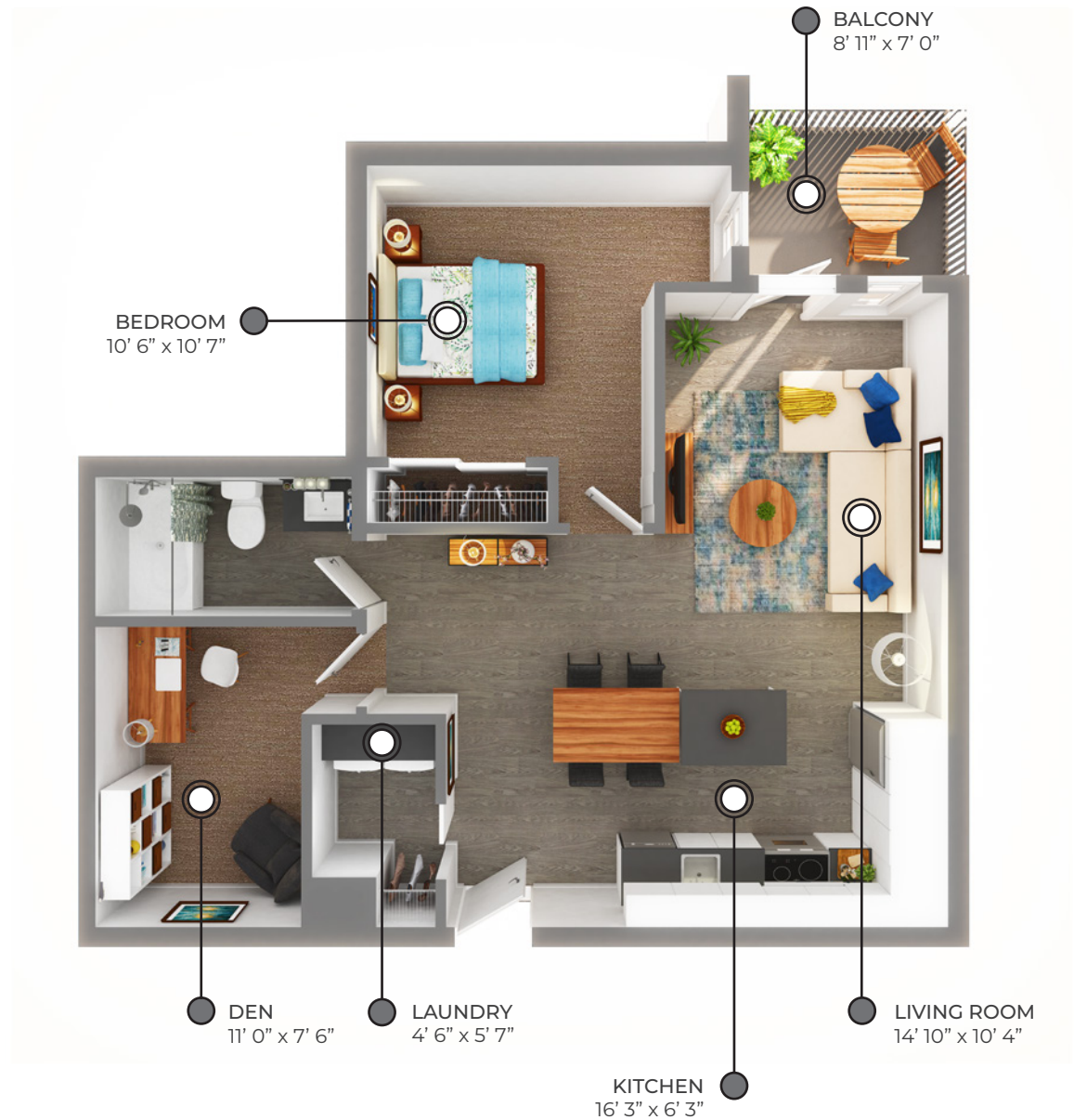

All suite measurements are preliminary based on current building
concept and unit configurations and are subject to change.



MEREWOOD APARTMENTS

411 & 423 Despard Avenue
Parksville, BC

CHERRY 728 sq ft

The floor plan illustrated here
includes these finishes:



CABINETRY:
FLAT SLAB

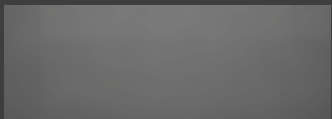

COUNTERS:
QUARTZ

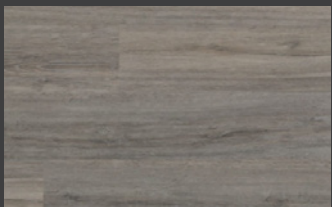

FLOORING:
LUXURY
VINYL TILE



CARPET:
TEXTURED
CUT PILE



All suite measurements are preliminary based on current building concept and unit configurations and are subject to change.