



MEREWOOD APARTMENTS

377 & 385 Moilliet Street South
Parksville, BC

OAK

563-605 sq ft

The floor plan illustrated here
includes these finishes:

CABINETRY:
FLAT SLAB

COUNTERS:
QUARTZ

FLOORING:
LUXURY
VINYL TILE



- | | | | |
|--|---|------------------------------------|-----------------------------------|
| 1 Kitchen/Dining
15' 4" x 12' 2" | 2 Living Room
15' 8" x 12' 2" | 3 Bathroom
5' x 9' 2" | 4 Bedroom
11' x 10' 10" |
| 5 Walk-thru Closet
3' 7" x 8' | 6 Laundry
3' x 5' | 7 Balcony
6' 11" x 9' 8" | |

Please note, all floor plans and photos are provided for illustrative purposes only. ALL MEASUREMENTS ARE APPROXIMATE. Actual layouts may be different than shown and could vary in size and scale. merewoodapartments.ca



MEREWOOD APARTMENTS

377 & 385 Moilliet Street South
Parksville, BC

HAZELNUT 639-678 sq ft

The floor plan illustrated here
includes these finishes:



CABINETRY:
FLAT SLAB



COUNTERS:
QUARTZ



FLOORING:
LUXURY
VINYL TILE

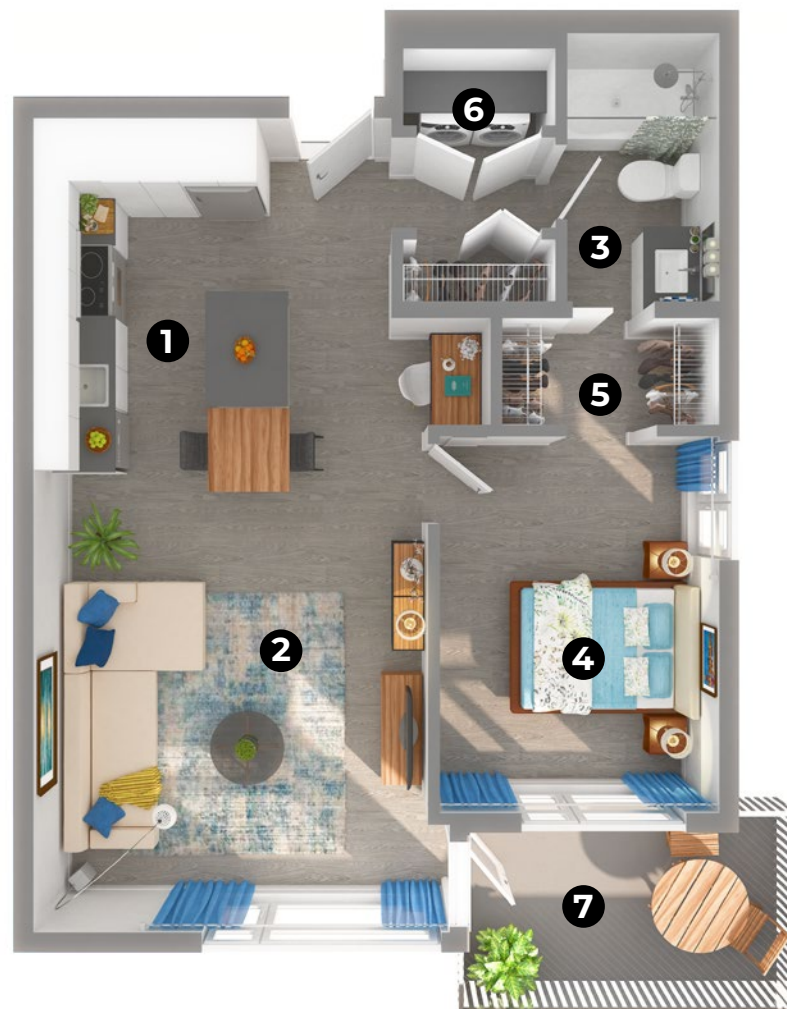

- | | | | | |
|--|--------------------------------------|---------------------------------|----------------------------------|---|
| 1 Kitchen/Dining
11' 3" x 15' 3" | 2 Living Room
11' 3" x 12' | 3 Bathroom
5' x 9' 6" | 4 Bedroom
12' x 11' 2" | 5 Walk-thru Closet
9' x 3' 6" |
| 6 Laundry
6' 6" x 3' | 7 Balcony
10' 2" x 7' | | | |

Please note, all floor plans and photos are provided for illustrative purposes only. ALL MEASUREMENTS ARE APPROXIMATE. Actual layouts may be different than shown and could vary in size and scale. merewoodapartments.ca



MEREWOOD APARTMENTS

377 & 385 Moilliet Street South
Parksville, BC

HICKORY 653 sq ft

The floor plan illustrated here
includes these finishes:



CABINETRY:
FLAT SLAB



COUNTERS:
QUARTZ



FLOORING:
LUXURY
VINYL TILE



- | | | | | |
|--|------------------------------------|---------------------------------|-------------------------------------|---|
| 1 Kitchen/Dining
11' x 11' 10" | 2 Living Room
11' x 13' | 3 Bathroom
5' x 9' 2" | 4 Bedroom
11' 2" x 11' 9" | 5 Walk-thru Closet
5' 8" x 5' |
| 6 Laundry
3' 6" x 4' 9" | 7 Balcony
10' 2" x 6' 7" | | | |

Please note, all floor plans and photos are provided for illustrative purposes only. ALL MEASUREMENTS ARE APPROXIMATE. Actual layouts may be different than shown and could vary in size and scale. merewoodapartments.ca



MEREWOOD APARTMENTS

411 & 423 Despard Avenue
Parksville, BC

HAWTHORN

524 sq ft

The floor plan illustrated here
includes these finishes:

CABINETRY:
FLAT SLAB

COUNTERS:
QUARTZ

FLOORING:
LUXURY
VINYL TILE

CARPET:
TEXTURED
CUT PILE



All suite measurements are preliminary based on current building
concept and unit configurations and are subject to change.



MEREWOOD APARTMENTS

411 & 423 Despard Avenue
Parksville, BC

ALDER 544-567 sq ft

The floor plan illustrated here
includes these finishes:

CABINETS:
FLAT SLAB

COUNTERS:
QUARTZ

FLOORING:
LUXURY
VINYL TILE

CARPET:
TEXTURED
CUT PILE

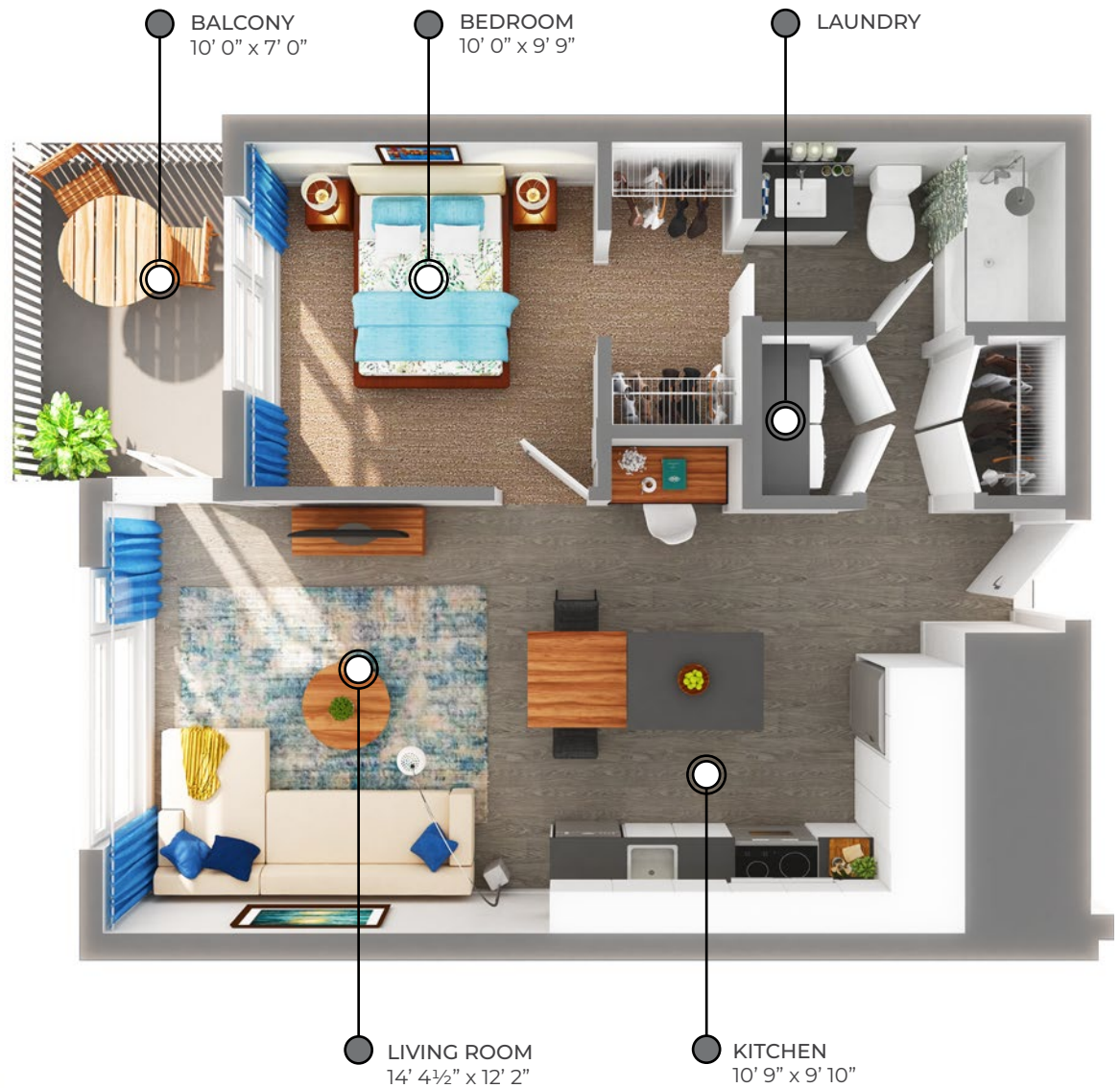

All suite measurements are preliminary based on current building
concept and unit configurations and are subject to change.



MEREWOOD APARTMENTS

411 & 423 Despard Avenue
Parksville, BC

MAPLE

548 sq ft

The floor plan illustrated here
includes these finishes:



CABINETRY:
FLAT SLAB

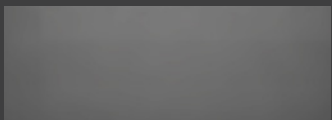

COUNTERS:
QUARTZ

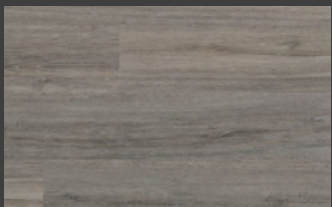

FLOORING:
LUXURY
VINYL TILE



CARPET:
TEXTURED
CUT PILE

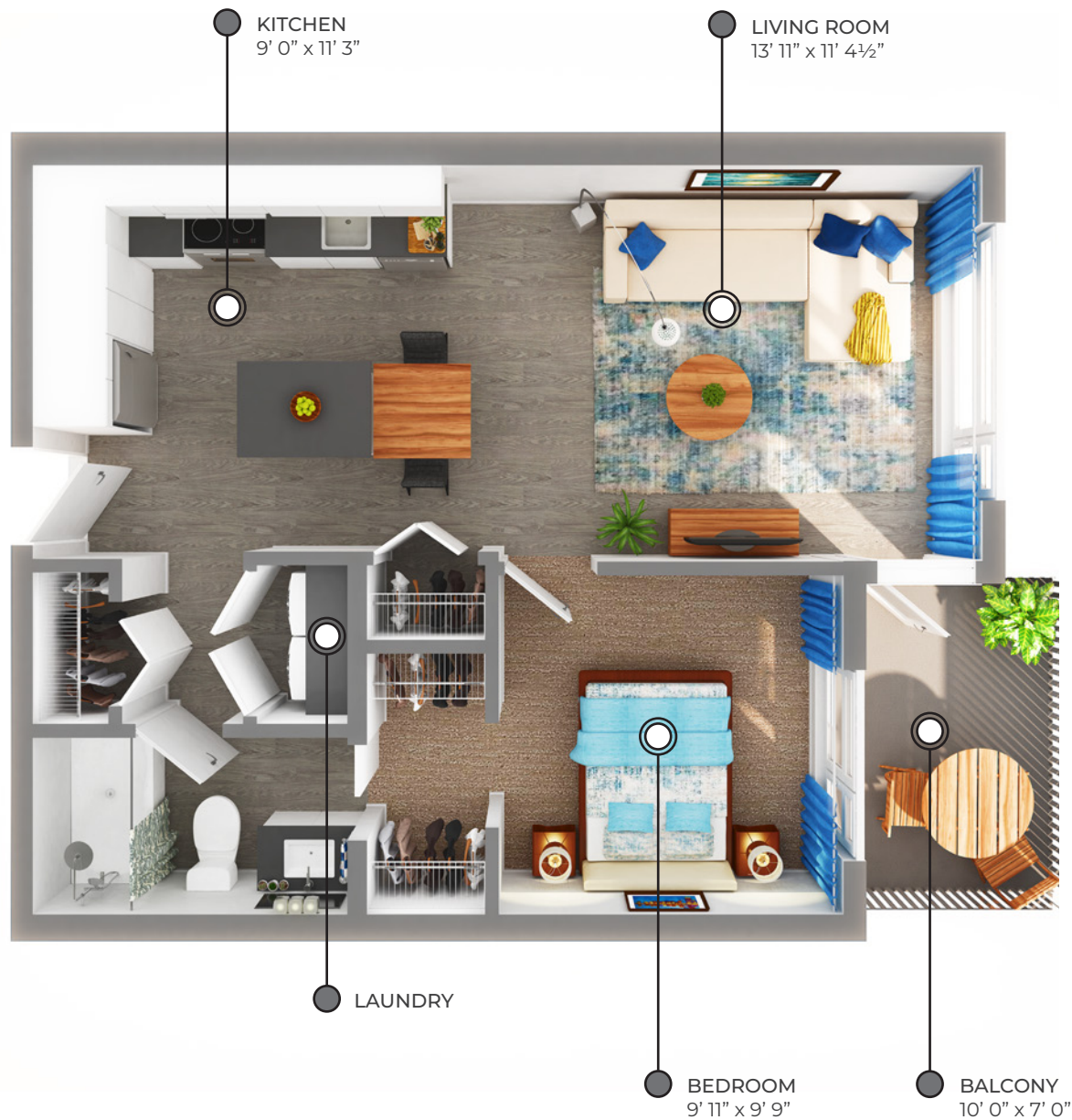

All suite measurements are preliminary based on current building
concept and unit configurations and are subject to change.



MEREWOOD APARTMENTS

411 & 423 Despard Avenue
Parksville, BC

LARCH

572 sq ft

The floor plan illustrated here
includes these finishes:



CABINETRY:
FLAT SLAB

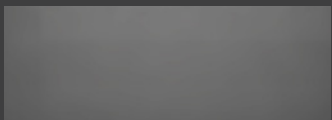

COUNTERS:
QUARTZ

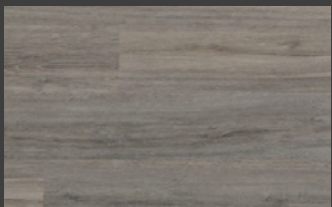

FLOORING:
LUXURY
VINYL TILE



CARPET:
TEXTURED
CUT PILE



All suite measurements are preliminary based on current building
concept and unit configurations and are subject to change.



MEREWOOD APARTMENTS

411 & 423 Despard Avenue
Parksville, BC

LINDEN

586 sq ft

The floor plan illustrated here
includes these finishes:

CABINETRY:
FLAT SLAB

COUNTERS:
QUARTZ

FLOORING:
LUXURY
VINYL TILE

CARPET:
TEXTURED
CUT PILE



All suite measurements are preliminary based on current building
concept and unit configurations and are subject to change.



MEREWOOD APARTMENTS

411 & 423 Despard Avenue
Parksville, BC

HAZELNUT

615 sq ft

The floor plan illustrated here
includes these finishes:

CABINETRY:
FLAT SLAB

COUNTERS:
QUARTZ

FLOORING:
LUXURY
VINYL TILE

CARPET:
TEXTURED
CUT PILE



All suite measurements are preliminary based on current building concept and unit configurations and are subject to change.



MEREWOOD APARTMENTS

411 & 423 Despard Avenue
Parksville, BC

WILLOW 704 sq ft

The floor plan illustrated here
includes these finishes:



CABINETRY:
FLAT SLAB

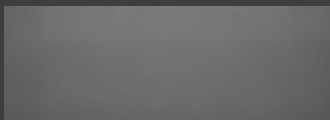

COUNTERS:
QUARTZ

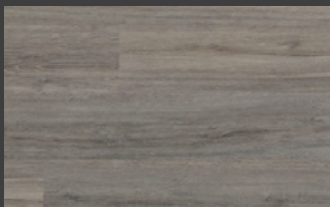

FLOORING:
LUXURY
VINYL TILE



CARPET:
TEXTURED
CUT PILE



All suite measurements are preliminary based on current building
concept and unit configurations and are subject to change.