

ROSE

2 BEDROOM, 2 BATHROOM

924 sq. ft.



Room Dimensions

① Kitchen/Dining	12' 5" x 12' 1"	⑤ Ensuite	5' 7" x 9' 2"
② Living Room	12' 1" x 12' 5"	⑥ Bedroom	11' 2" x 11' 6"
③ Bathroom	5' x 7' 6"	⑦ Laundry	8' 3" x 3' 7"
④ Bedroom	11' 2" x 11' 6"	⑧ Balcony	12' 1" x 6' 4"

All measurements are approximate.

Actual suite layouts, features, and finishes may vary in size and scale and are subject to change.



Floor One

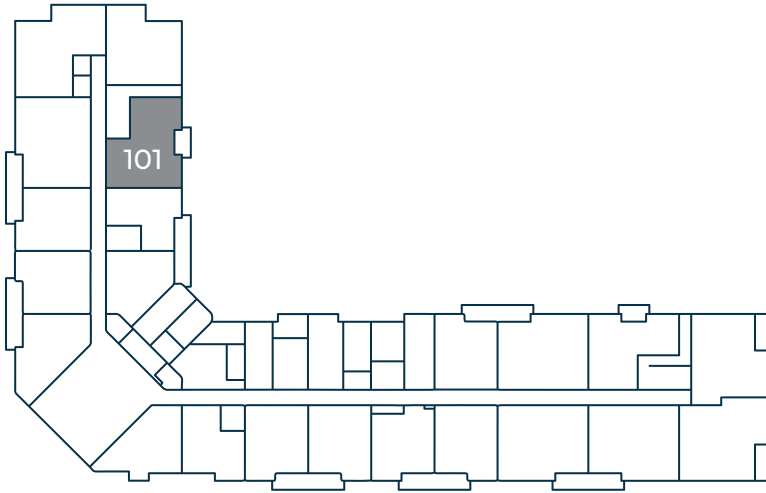

Floor Two - Six

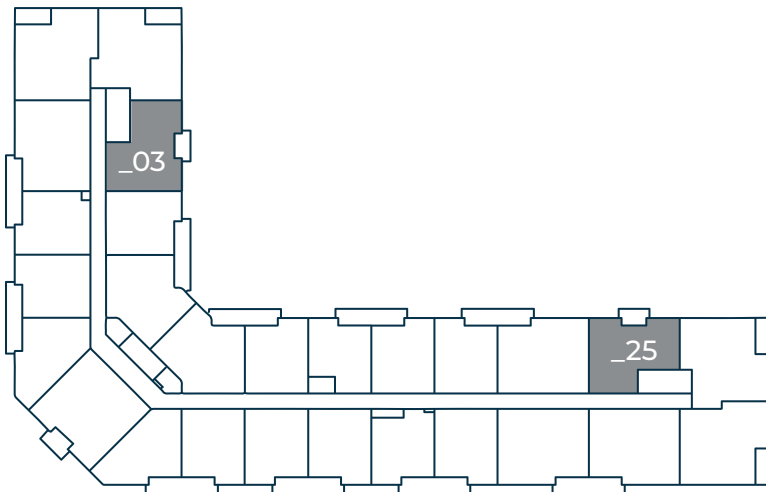

THE EARL

2 BEDROOM, 2 BATHROOM*

1018 sq. ft.



*Corner Unit

Room Dimensions

① Kitchen/Dining	15' 3" x 9' 3"	⑥ Ensuite	5' 1" x 8' 3"
② Living Room	13' 2" x 10'	⑦ Bedroom	10' 5" x 12'
③ Bathroom	7' 9" x 5' 3"	⑧ Laundry	3' 9" x 4' 8"
④ Bedroom	9' 9" x 11' 9"	⑨ Balcony	13' 2" x 6' 4"
⑤ Walk-in Closet	6' x 5' 3"		

All measurements are approximate.

Actual suite layouts, features, and finishes may vary in size and scale and are subject to change.



Floor One

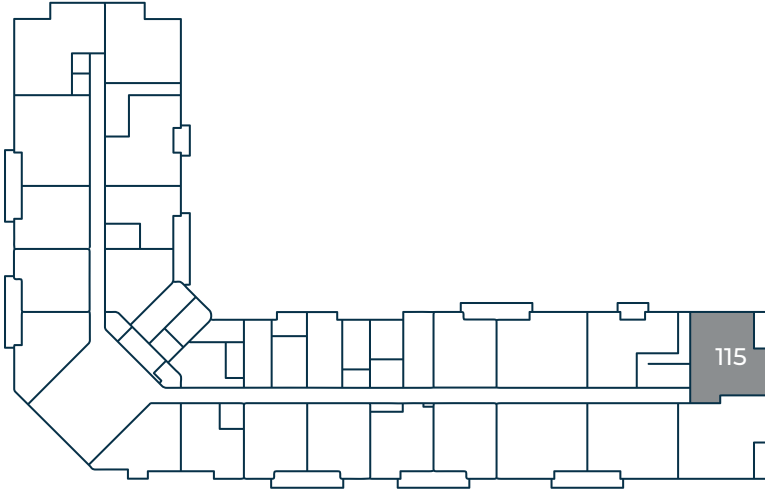

THE TEMPEST

2 BEDROOM, 2 BATHROOM*

1073 sq. ft.



*Corner Unit

Room Dimensions

1 Kitchen	12' 5" x 10' 5"	6 Ensuite	5' 2" x 10' 6"
2 Living/Dining	17' 8" x 11' 8"	7 Bedroom	10' 4" x 11' 2"
3 Bathroom	9' 1" x 5' 3"	8 Walk-in Closet	9' 1" x 5' 9"
4 Bedroom	10' 2" x 11' 8"	9 Laundry	4' 10" x 4' 3"
5 Walk-in Closet	5' 1" x 6'	10 Balcony	6' 4" x 13' 2"

All measurements are approximate.

Actual suite layouts, features, and finishes may vary in size and scale and are subject to change.

Floor One

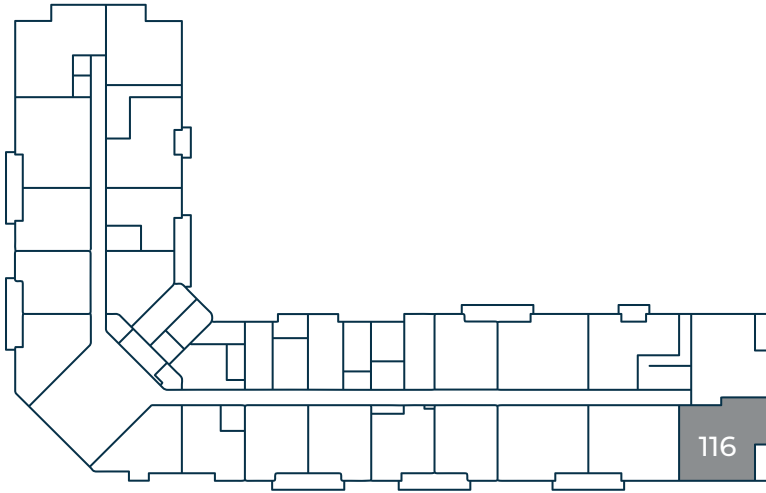

Floor Two - Six

