

THE DUKE

2 BEDROOM, 2 BATHROOM

1054 sq. ft.



Room Dimensions

① Kitchen/Dining	10' 5" x 8' 6"	⑤ Ensuite	7' 3" x 9' 7"
② Living Room	13' 7" x 16' 3"	⑥ Bedroom	10' 3" x 11' 7"
③ Bathroom	9' 5" x 5' 1"	⑦ Laundry	6' 8" x 7' 2"
④ Bedroom	10' 6" x 18' 8"	⑧ Balcony	13' 2" x 6' 4"

All measurements are approximate.

Actual suite layouts, features, and finishes may vary in size and scale and are subject to change.



Floor One

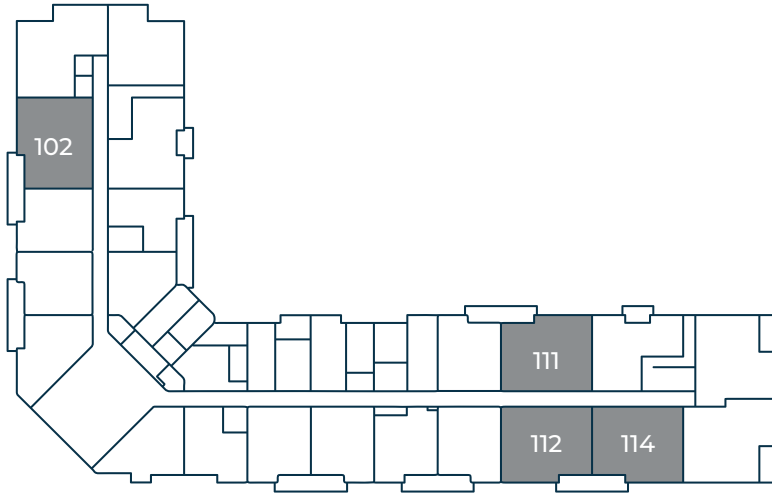

Floor Two - Six



THE QUEEN

2 BEDROOM, 2 BATHROOM*

1111 sq. ft.



*Corner Unit

Room Dimensions

① Kitchen	9' 8" x 13' 5"	⑥ Bedroom	10' 5" x 11' 5"
② Living/Dining	17' 5" x 12' 2"	⑦ Walk-in Closet	7' 1" x 5' 7"
③ Bathroom	9' 1" x 5'	⑧ Laundry	6' 1" x 9' 3"
④ Bedroom	10' 6" x 12'	⑨ Balcony	12' 2" x 6' 4"
⑤ Ensuite	10' 6" x 6' 6"		

All measurements are approximate.

Actual suite layouts, features, and finishes may vary in size and scale and are subject to change.



Floor Two - Six

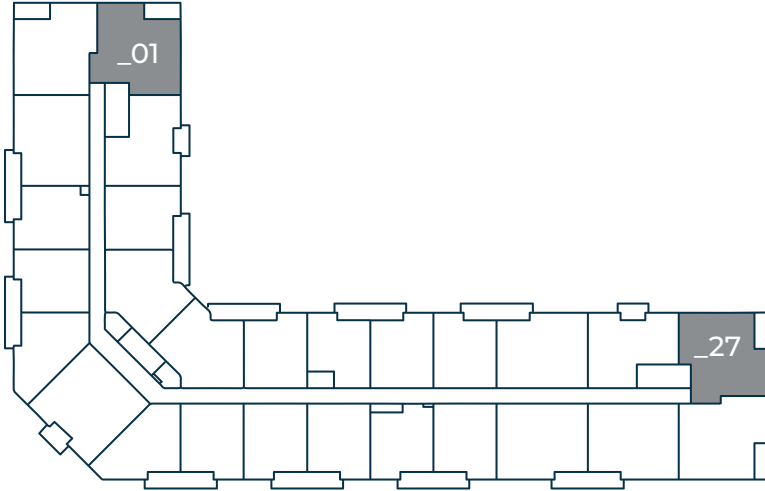

THE KING

2 BEDROOM +DEN, 2 BATHROOM

1159 sq. ft.



Room Dimensions

1 Kitchen/Dining	19' 5" x 9' 2"	6 Ensuite	5' 4" x 10'
2 Living Room	12' 1" x 12' 3"	7 Bedroom	10' 2" x 15' 3"
3 Bathroom	7' 7" x 7' 8"	8 Laundry	7' x 7' 5"
4 Bedroom	10' 2" x 15' 3"	9 Balcony	12' 1" x 6' 4"
5 Walk-in Closet	6' 1" x 7' 7"		

All measurements are approximate.

Actual suite layouts, features, and finishes may vary in size and scale and are subject to change.



Floor Two - Six

